

# Colourways

One stop shop for specialist interiors



# Welcome



Colourways features in the Pinders  
Health Care Design Awards 2006  
Specialist Care section.

Colourways is a one-stop shop for specialised interiors, providing furniture, household equipment and soft furnishings for residential homes. Colourways is an award winning company working in the private sector, for the NHS and for local authorities, delivering throughout the UK. We are happy to provide furniture and furnishings ranging from individual items through to complete homes.

Colourways provides a new concept in design for the contract market, achieving a fine balance between a homely hotel style look, whilst ensuring a safe, robust and fit for purpose environment. In accordance with NHS guidelines all our upholstered furniture is fire retardant to crib source 5. Curtains, bedding and soft furnishing are not only flame retardant, but are carefully colour coordinated to ensure that all important individuality. We believe attention to detail is paramount as first impressions are important.

Our friendly and approachable team have spent years working in a 'hands on' capacity with various client groups; from severely physically disabled with complex medical needs through to people whose behaviour can challenge even the most specialist provider.

**Your first impression will make a lasting impression...**

**Fiona Heinson**  
*Managing Director*

# Contents



Beech Living Range	2
Pine Living Range	4
Ash Living Range	7
Chairs	8
Sofas/Lounge Chairs	10
Specialist Care Chairs/Sofas	14
Birch Bedroom Range	16
Ash Bedroom Range	18
Pine Bedroom Range	20
Residential Bedroom Range	22
Range of Beds	24
Special Features	26
Strengthened Furniture	28
Made-To-Measure Curtains/Accessories	32
Fabric Selection/Bedding	34
Finishing Touches	35
Office Furniture	36

## Whatever you are seeking, Colourways Ltd can help...

If you don't find what you are looking for in this brochure CONTACT US we will be happy to take time to discuss your needs. We recognise that every customer is individual. Allow our experience to work for YOU.



# Beech Living Range

Our beech range creates a totally fresh and modern look. It is manufactured in carefully selected beech timbers and constructed to a high standard with dovetailed drawers. The products within this stylish lounge and dining range produce an attractive range of options that will modernise any living environment.

Please contact Colourways for information about other pieces in this range.





## Dressers/Cabinets



**2 Door/2 Drawer Small Sideboard**  
(H: 850 W: 1070 D: 460mm)  
**Small Dresser Top (open)**  
(H: 1140 W: 1070 D: 240mm)  
(available as separate pieces)



**2 Door/6 Drawer Large Sideboard**  
(H: 850 W: 1470 D: 460mm)  
**Large Dresser Top (open)**  
(H: 1140 W: 1470 D: 240mm)  
(available as separate pieces)



**Bookcase/Cupboard**  
(H:1800 W:900 D:350mm)

## Cabinets/Coffee Tables



**Console/Buffet Unit with Drawers**  
(H: 850 W: 1240 D: 350mm)



**Rectangular Coffee Table**  
(H:460 W:910 D:450mm)



**Square Coffee Table**  
(H:460 W:610 D:610mm)



**Corner TV/Video Unit with Wooden Doors**  
(H:550 W:1000 D:600mm)

## Dining Tables



**Rectangular Dining Table (wheelchair friendly)**  
(H: 760 W: 800 D: 1370mm)



**Round Dining Table (wheelchair friendly)**  
(H: 760 DIA: 1060mm)

# Pine Living Range

This collection is made of solid pine a timeless, versatile timber, with the option of a straight or cut out plinth.

Whether you require a modern or classic look, all items in this range are available in a selection of nine different colour stains. Or can be spray painted green, blue or pink if you would like an individual appearance.

All the furniture in this range is finished with a protective lacquer and in order to protect the top further the dining tables are treated with an acid cat treatment as standard.

We offer a range of different dining tables to suit all needs. If you see a table you like but need it in a different size please just ring.

## Special Requests:

- We can make the tables a different height to accommodate wheel chairs
- We can also cut out dining table plinths to allow easy access to wheel chairs
- Chairs can be fitted with skis
- Stools available to match the chairs of your choice
- A selection of different handles are available for this range

## Furniture Polish Finishes

Natural Laquer



Antique



Syntema Victorian



Traditional Victorian



Teak



French Oak



Walnut



Cherry



Dark Oak



*The above colours can either be finished using a matt or satin lacquer.*



## Dressers/Bookcases/Cabinets



**Open Top Dresser 3' (Also available 3'6'')**  
(H: 1990 W: 965 D: 510mm)



**Sussex Dresser with five spice Drawers 6'**  
(H: 1980 W: 1880 D: 420mm)



**Double Open Top Corner Cupboard with 1 internal fixed shelf**  
(H: 1850 W: 950 D: 470mm)  
Internal shelf is 362mm from internal base of cupboard



**Bookcase with fixed shelves on a plinth**  
(H: 915 W: 770 D: 230mm)



**Bookcase with adjustable shelves**  
(H: 1980 W: 965 D: 280mm)  
Also available with 2 drawers



**Panelled Hi-Fi Cabinet**  
(H: 840 W: 535 D: 450mm)  
Supplied with 1 moveable shelf

## Television Cabinets



**Video/DVD Cabinet with door and drawer**  
(H: 560 W: 1040 D: 470mm)



**1 Drawer Corner TV Entertainment Cabinet**  
(H: 590 W: 930 D: 500mm)



**TV and Video Cabinet with drawer and 2 doors**  
(H: 1065 W: 915 D: 610mm)  
Internal TV Section:  
(H: 585 W: 660 D: 508mm)  
We undertake to construct any size to fit most televisions.



## Tables



**Classic Farmhouse  
3' Square Coffee Table on 4" legs**  
(H: 410 W: 915 D: 915mm)



**Refectory Coffee Table with shelf**  
(H: 490 W: 1070mm D: 610)



**Cornish 1 Drawer 2' Square Coffee/  
Lamp Table with Shelves**  
(H:584 W:610 D: 610mm)



**4 Drawer Round Coffee Table**  
(H: 450 Diam: 950mm)



**Oval Nest of Tables**  
(H: 475 W: 788 D: 483mm)



**Panelled Box**  
(H: 610 W: 940 D: 430mm)



**Premier Thick Top (44mm) Farmhouse Table  
with 5" legs**  
(H: 780 W: 2130 D: 910mm)  
Height of all tables 780mm



**Shaker Style Refectory Table with 4" legs**  
(H: 770 W: 1830 D: 860mm)  
Height of all tables 770mm



**Drum Extending Flip Top Table**  
(H: 750 Diam: 1100mm)  
Extending to 1524mm  
Also available with Fixed Top



**Twin Pedestal Flip Top  
Extending Table**  
(H: 775 L: 1600\* W: 1015mm)  
\*Extending to 2000mm



**51" Rectangular Gateleg  
Dining Table**  
(H: 740 W: 1290 D: 910mm)  
Width when folded 450mm



## Ash Living Range

This beautifully designed and manufactured range has proved to be extremely popular; it is built to a high specification with dovetail drawers, 10mm radius corners and hardened lacquer finish, teamed with its natural style will transform any living area.

### Bookcases/Cabinets



**Tall Bookcase**

H:1800 W: 900 D: 350mm



**Corner Display Cabinet**

H:1800 W: 850 D: 450mm



**Corner TV Cabinet**

H:550 W: 920 D: 550mm



**3 Drawer Sideboard**

H:850 W: 1320 D: 440mm

### Tables



**Hall Console Table**

H:780 W: 1200 D: 500mm

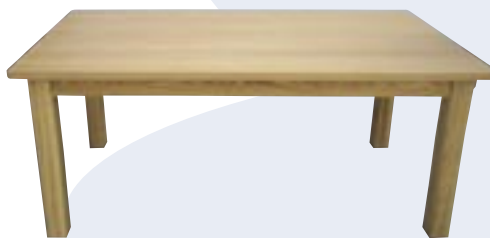

**Large Dining Table**

H:750 W: 1020 D: 1830mm

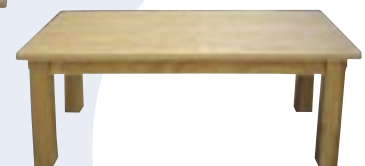

**Coffee Table**

H:370 W: 940 D: 460mm

## Chairs

Colourways offers a wide variety of dining chairs to suit all homes and environments. These are available in a choice of polished finishes and can be upholstered in a wide variety of fabrics and leathers. Please call for samples or visit our website [www.colourwaysltd.com](http://www.colourwaysltd.com) for the full range.

We only use high quality acid cat laquers, which are available in either matt or high sheen finish.



**Beech Contract Side Chair**  
(H: 890 W: 480 D: 520mm)



**Beech Contract Carver**  
(H: 890 W: 560 D: 520mm)  
Shown with optional skis



**Heavy Slat Low Carver**  
(H: 900 W: 300 D: 445mm)



**Heavy Slat Side Chair**  
(H: 850 W: 400 D: 395mm)



**Ladderback Armchair**  
(H: 490 W: 430 D: 460mm) Overall H: 950mm  
W: (between arms) 570mm  
Available with or without arms

### Furniture Polish Finishes

Natural Laquer



Antique



Syntema Victorian



Traditional Victorian



Teak



French Oak



Walnut



Cherry



Dark Oak



## Chairs



**Luke Upholstered Side Chair**  
(H: 830 W: 440 D: 510mm)  
Also available with veneer seat



**Margarita Side Chair**  
(H: 830 W: 440 D: 410mm)  
Also available with upholstered seat



**Joel Upholstered Side Chair**  
(H: 860 W: 440 D: 510mm)  
Also available with veneer seat



**Heavy Shaker Wooden Seated Side Chair**  
(H: 1080 W: 490 D: 430mm)  
Also available with upholstered seat



**Heavy Shaker Carver Wooden Seat**  
(H: 1060 W: 445 D: 495mm)



**Kent Upholstered Side Chair**  
(H: 1010 W: 475 D: 490mm)  
Also available with wooden seat



**Droxford Chair with Skis**  
(Overall H: 855 W: 575mm)  
(Seat H: 460 W: 460mm)  
Also available without arms and without skis



**Blendworth Dining Chair**  
(Overall H: 915 W: 485mm)  
(Seat H: 495 W: 430mm)



**Durley Arm Chair with Skis**  
(Overall H: 825 W: 550mm)  
(Seat H: 460 W: 460mm)  
Also available without arms and without skis



**Boston Leather Chair**  
(H: 1005 W: 463 D: 508mm)



**Compton Arm Chair**  
(Overall H: 865 W: 535mm)  
(Seat H: 485 W: 460mm)



**Compton Side Chair**  
(Overall H: 865 W: 460mm)  
(Seat H: 485 W: 460mm)

# Sofas/Chairs

All of the sofas and chairs in this range are made with solid hardwood frames with re-inforced arms. Sprung upholstered bases are used for longer lasting support and seats can be boarded for extra heavy usage as an optional extra.

The wood feet come in a choice of 4 colours and we offer a huge range of waterproof wipe clean fabrics for fixed upholstery or loose covers for machine washing.





## Sofas



**Berkshire**

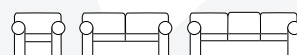

**Hampshire**

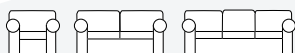

**Dorset**

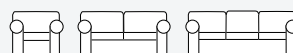

	Chair	Two-seater Sofa	Two ½ seater Sofa	Three-seater Sofa	Footstool
Overall Height	990mm	990mm	990mm	990mm	370mm
Overall Width	790mm	1350mm	1500mm	1900mm	545mm
Overall Depth	840mm	840mm	840mm	840mm	470mm
Seat Height	470mm	470mm	470mm	470mm	
Seat Depth	530mm	530mm	530mm	530mm	

## Sofas

Colourways aims to supply furniture for all rooms including smaller sofas/easy chairs for visitors' rooms

### Dorchester

	Chair	Two-seater Sofa	Three-seater Sofa
Overall Height	735mm	735mm	735mm
Overall Width	940mm	1445mm	1880mm
Seat Height	460mm	460mm	460mm
Seat Width	510mm	1090mm	1525mm



### Strand

	Chair	Two-seater Sofa	Cube Stool
Overall Height	787mm	790mm	430mm
Overall Width	710mm	1270mm	430mm
Seat Height	460mm	460mm	430mm (Depth)
Seat Width	405mm	965mm	
Seat Depth	430mm	430mm	

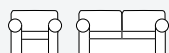

### Charlton

	Chair	Two-seater Sofa
Overall Height	860mm	860mm
Overall Width	750mm	1220mm
Seat Height	460mm	460mm
Seat Width	460mm	920mm



## Chairs



**Empire**

Overall Height 735mm  
Overall Width 725mm  
Seat Height 470mm  
Seat Width 460mm



**Lambeth Tub**

775mm  
580mm  
460mm  
445mm



**Roma**

825mm  
540mm  
460mm  
470mm



**Sunbury**

Overall Height 780mm  
Overall Width 740mm  
Seat Height 420mm  
Seat Width 460mm



**Charlton**

860mm  
750mm  
460mm  
460mm



**Strand**

787mm  
710mm  
460mm  
405mm



## Specialist Care Chairs/Sofas



### Bembridge



	Chair	Two-seater Sofa	Footstool
Overall Height	1100mm	1065mm	255mm
Overall Width	790mm	1270mm	410mm
Seat Height	485mm	485mm	305mm (Depth)
Seat Width	485mm	1015mm	
Seat Depth	485mm	495mm	

### Contract Quality Frame



#### Chair specifications

- Solid hardwood frames – wooden legs
- Sprung upholstered base
- Good lumbar supports
- Hygiene gaps to allow fluids to escape
- Variable seat heights
- Wood colours – Natural Beech, Teak, Medium Oak or Mahogany
- Huge range of fire retardant fabrics. Please call for FREE samples available or visit our website [www.colourwaysltd.com](http://www.colourwaysltd.com) for the full range.

**Dowelled, glued and pinned joints for extra strength**

#### Wood Samples

Natural Beech



Teak



Medium Oak



Mahogany



**Steel springs for longer lasting support**



## Chairs



**Hertford**

Overall Height	1095mm
Overall Width	660mm
Seat Height	510mm
Seat Width	460mm
Seat Depth	



**Shaftesbury**



1140mm
810mm
485mm
470mm
495mm



**Berkeley**



1100mm
750mm
485mm
535mm
485mm



**Albany**

Overall Height	990mm
Overall Width	790mm
Seat Height	460mm
Seat Width	485mm
Seat Depth	495mm



**Windsor**

1095mm
810mm
485mm
495mm
495mm



### Manual Recliner Specification

Solid hardwood frame – built to last.  
Three comfortable seating positions.

Space saving 'wall hugger' action.  
Huge range of flame retardant  
fabrics available (Please call for FREE  
samples available or visit our website  
[www.colourwaysltd.com](http://www.colourwaysltd.com) for the  
full range.)

# Birch Bedroom Range

This range offers a fresh and beautifully proportioned collection of bedroom pieces made only from solid birch and real birch veneers. This furniture creates a feeling of light and space in any bedroom. It is distinguished by the striking simplicity of its design and is available in a stunning natural finish or pale cherry, fitted with brushed aluminium handles. The pieces within this range are available made in radiata wood with filled in plinth and cut out handles (as pictured opposite). Visit our website [www.colourwaystld.com](http://www.colourwaystld.com) to see the full range of this product.

Wood Samples

Natural

Pale Cherry



## Bedside Cabinets



**1 Drawer/1Door Bedside Cabinet**  
(H: 580 W: 430 D: 425mm)



**3 Drawer Bedside Cabinet**  
(H: 580 W: 430 D: 425mm)  
(H: 636 W: 515 D: 425mm)



**Narrow Chest**  
(H: 1106 W: 515 D: 425mm)

## Chest of Drawers/Dressing Table



**3 + 2 Chest of Drawers**  
(H: 916 W: 915 D: 425mm)  
(H: 945 W: 915 D: 425mm)



**7 Drawer Combi Chest**  
(H: 846 W: 1300 D: 425mm)



**Dressing Table**  
(H: 771 W: 1225 D: 425mm)  
(H: 715 W: 1285 D: 425mm)  
**Stool** (H: 450 W: 440 D: 340mm)

## Wardrobes/Headboard



**All Hanging Wardrobe**  
(H: 1900 W: 900 D: 625mm)  
(H: 1900 W: 760 D: 625mm)



**2 Drawer Wardrobe**  
(H: 1900 W: 900 D: 625mm)

Top boxes available please telephone for details.



**Single Headboard**  
(H: 600 W: 1000 D: 30mm)  
**Double Headboard**  
(H: 600 W: 1500 D: 30mm)

**Solid Radiata with cut out handles**





# Ash Bedroom Range

The solid Ash range that we offer is beautifully designed and manufactured to the following very high specification:-

- Heavy contract construction
- Metal runners to drawers
- Cut-out at rear for skirting boards
- 10mm radius on corners
- Hardened lacquer finish
- Fully railed carcasses
- Fully dovetailed drawers





## Bedside Cabinets/Headboard



**Three-Drawer Bedside Cabinet with Locking Top Drawer**  
(H: 660 W: 515 D: 425mm)



**One-Drawer/One-Door Bedside Cabinet**  
(H: 660 W: 515 D: 425mm)



**Single Headboard**  
(H: 600 W: 990 D: 25mm)  
**Double Headboard**  
(H: 600 W: 1380 D: 25mm)

## Chest of Drawers/Dressing Table



**3 + 2 Chest of Drawers**  
(H: 950 W: 915 D: 425mm)  
(H: 1150 W: 915 D: 425mm)



**Large Single Pedestal Dressing Table**  
(H: 750 W: 1225 D: 425mm)

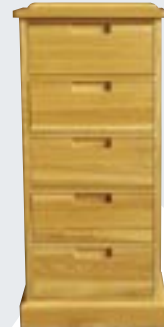

**Chest of Drawers 5 Drawer Narrow**  
(H: 1106 W: 515 D: 425mm)

## Wardrobes



**Two-Door All Hanging Wardrobe**  
(H: 1900 W: 900 D: 625mm)  
Also available with 2 drawers



**Combination Wardrobe**  
(H: 1900 W: 900 D: 625mm)



**2 Door/2 Drawer Wardrobe**  
(H: 1900 W: 900 D: 625mm)

# Pine Bedroom Range

The Pine Range is a traditional collection of bedroom pieces made from solid Pine with a choice of cut out or straight plinths. This range is available in a selection of nine colours so that rooms can be individualised.

A variety of additional sizes and designs are available in this range. For bespoke items or special requirements please contact Colourways.

## Furniture Polish Finishes

Natural Laquer



Antique



Syntema Victorian



Traditional Victorian



Teak



French Oak



Walnut



Cherry



Dark Oak



## Bedside Cabinets/Dressing Table



**3-Drawer Chest**  
(H: 610 W: 440 D: 370mm)



**Bedside Cabinet**  
(H: 610 W: 440 D: 370mm)



**Single Pedestal Dressing Table**  
(H: 740 W: 1070 D: 450mm)  
**Stool (Available in blue, beige green or pink)**  
(H: 510 W: 430 D: 300mm)

## Chest of Drawers



**Two Plus Three Chest**  
(H: 990 W: 870 D: 450mm)



**7-Drawer Wellington Chest**  
(H: 1070 W: 650 D: 380mm)



**7-Drawer Chest**  
(H: 710 W: 1520 D: 460mm)

## Wardrobes



**3' One Drawer Wardrobe**  
(H: 1980 W: 1020 D: 650mm) also available with 2 drawers and triple with 5 drawers



**4' All Hanging Wardrobe**  
(H: 1980 W: 1220 D: 650mm)



**Combination Wardrobe**  
(H: 2000 W: 1010 D: 650mm)



# Residential Bedroom Range

Our residential bedroom range has been carefully selected in four very different designs to provide a homely feel whilst at the same time meeting the needs for long life, durability and value for money.

Shown below are the Alpha, Milton, Lancombe and Forest ranges:

The **Alpha** range is designed to provide a collection of versatile pieces in four different colours. The bold moulding manufactured in MDF on all doors and drawers provide a traditional cottage appearance manufactured to a high quality, which is, finished with solid wooden knobs, 170 degree metal hinges and chrome hanging rails.



## The Forest range has been designed to the following specifications:

- 18mm MFC carcass throughout
- 18mm door and drawer fronts melamine faced MDF
- All chest/desk tops 25mm thickness
- 170 degree all metal hinges
- 4 sided drawer boxes
- 3mm PVC impact-resistant edging available in matching or contrasting colours
- No handles – well designed cut-outs

The success of this range to date is seen in universities and colleges.



The **Milton** and **Lancombe** ranges offer alternative door designs with matching melamine carcasses. Milton doors are 'shaker' style, whilst Lancombe are routed and contoured. Both ranges are available in Maple or Golden Beech.

## Finishes Available

Limed Oak	
Beech	
Cherry	
Maple	
Golden Beech	
Light Oak	



## Bedside Cabinets



**2 drawer bedside**  
(H: 485 W: 460 D: 460mm)



**3 drawer bedside**  
(H: 660 W: 460 D: 460mm)



**1 drawer open bedside**  
(H: 660 W: 460 D: 460mm)



**1 drawer & door bedside**  
(H: 660 W: 460 D: 460mm)

## Chest of Drawers



**3 drawer chest**  
(H: 660 W: 610 D: 460mm)  
or (H: 660 W: 762 D: 460mm)



**4 drawer chest**  
(H: 840 W: 610 D: 460mm)  
or (H: 840 W: 762 D: 460mm)



**5 drawer chest**  
(H: 1020 W: 610 D: 460mm)  
or (H: 1020 W: 762 D: 460mm)

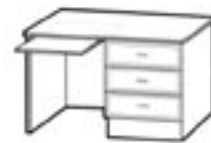

**Writing Desk**  
**(Optional pullout tray)**  
(H: 762 W: 1143 D: 610mm)

## Dressing Tables/Headboards



**Single dressing table**  
(H: 760 W: 990 D: 460mm)



**Double dressing table**  
(H: 760 W: 1525 D: 460mm)

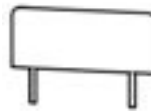

**Single Headboard**  
Single (H: 406 W: 915 mm)



**Double Headboard**  
Double (H: 406 W: 1370 mm)

## Wardrobes

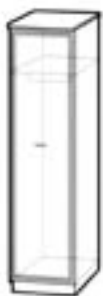

**Single wardrobe**  
(H: 1830 W: 460 D: 535mm)



**Double wardrobe**  
(H: 1830 W: 760 D: 535mm)



**2 drawer wardrobe**  
(H: 1830 W: 760 D: 535mm)



**Top Box**  
(H: 405 W: 460 D: 535mm)  
(H: 405 W: 760 D: 535mm)

# Range of Beds

The contract bed range is produced to comply with BS7177 source crib 5, medium hazard. These beds are designed for nursing homes, hotels, hostels, holiday camps, boarding schools etc.



## Beds



### Hotel Superb

Comfortable yet firm contract quality divan set. 100% cotton cover, fully tufted with handles and side vents. Conforms to BS7177 Ignition Source 5. Headboard available separately



### Hotel Elite

Ideal contract divan set. Available with microquilt or tufted mattress. Cotton cover. Conforms to BS7177 Ignition Source 5. Headboard available separately



### Adjustable Height Divan Set

Height settings from 610 – 740mm manual action. Covered in Nautilus water resistant breathable PVC (also available as fully waterproof) conforms to BS7177 Ignition Source 5. Headboard available separately.



### Harvard

Hard wearing contract divan set, ideal for all bedrooms. Covered in a strong stitchbond microquilted cover. Conforms to BS7177 Ignition Source 5. Headboard available separately.



### Healthcare Plus Nautilus Breathable PVC

Heavy duty contract divan with 13.5 gauge spring unit. Incorporating the non-slip, water resistant, breathable PVC mattress. Conforms to BS7177 Ignition Source 5.

### Special Requests:

- Fire crib source 7 is available on request
- If you require an extra long bed (for a tall person) or a special strength or size; please call for details
- Split bases are also available for difficult or tight spaces
- Draws can be added to most bases
- Deep based divan beds are supplied as standard, however, bed bases can be supplied with legs, please call for details
- Fully waterproof mattress available

## Special Features

One of the most difficult tasks for us is to provide furniture that is homely in appearance and yet will stand up to some abuse. No furniture is totally indestructible if someone has a mind to break it but our furniture will give the home a fighting chance.

### Practical & Durable

As standard, curtains are made from FR fabrics with a Velcro tab top so that if someone is a bit heavy handed the curtain will release easily from the pole, leaving the pole and wall intact therefore reducing maintenance costs.

We are regularly asked to provide polycarbonate for use as non breakable mirrors and in picture frames as protection instead of glass.



### Additional Features

We are happy to provide wardrobes with an additional rail as pictured so that clothes can be reached from a wheel chair. Sofas can be built with ground clearance so that a hoist can be used under them; please speak to Colourways for expert advice.

### Specialised Solutions

Dining room tables are often not the correct height to seat dining and wheel chairs. We feel that dining is a very social occasion and it is important that all eating feel comfortable and included so we are able to offer two solutions.

The furniture manufacturer we use, on request, will make the table up with a lip of the table cut out so that wheel chairs and dining chairs will both fit under. The alternative is to provide a height adjustable table, which can be set accordingly. We are often asked to provide chairs with skis so that people can be assisted up to the table as the skis will run across the floor.





## Special Features



### Furniture That Lasts

There is often a need to board the sofas with ply board and this is very effective in prolonging the life of sofas and chairs. All sofas are to crib 5 and can be fitted with fixed waterproof or removable washable covers.

Very occasionally we are asked to produce sofas and chairs that can be inspected underneath for sharps or other substances for this end we have developed a sofa with Perspex fixed to the base.



### Safety

We are regularly asked to provide polycarbonate in items such as TV cabinets, non breakable mirrors and in picture frames as protection instead of glass.



### Reducing the Risk

For the more severely challenging or mental health units there are often concerns around ligature points. In these instances we would recommend the use of anti ligature handles on furniture and magnetic fixings for curtain tracks, shower heads, wardrobe poles etc.

In these instances furniture is generally fitted with security screw fixings and 270 degree hinges.



# Strengthened and Specialised Furniture

Colourways offers you a range of furniture, which is specifically designed to meet the needs of demanding environments. High quality materials and construction features provide greater strength and durability than conventional mass-produced furniture: Genuine cost-effectiveness is achieved through a long useful life, backed by after-sales support for effective maintenance. Component parts such as drawers can be replaced if broken. The straightforward style of this furniture is made with hardwearing wipe clean melamine-faced mdf and is offered in a wide choice of colours and wood grain effects to help you create the perfect surroundings for your home.

## Furniture Colours and Finishes

Soft Blue



Baltic Blue



Lilac



Racing Green

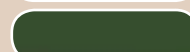

Jade



Morello



Beech



Lime Oak



Ash



## Chest of Drawers/Bedside Cabinets



### Large Chest of Drawers

(H: 795 W: 810 D: 535mm)

Also available in small with 3 drawers and medium with 4 drawers.



### Bedside Cupboard with Drawer 1 drawer and door

(H: 630 W: 410 D: 410mm)



### Bedside Cupboard

(H: 630 W: 410 D: 410mm)

## Wardrobes



### Double Wardrobe Full hanging with 1 shelf, 2 sections bolt together.

(H: 1775 W: 800 D: 610mm)

Also available as single.



### Double Wardrobe with 3 Drawers Half hanging, internal shelves and 3 drawers.

(H: 1775 W: 800 D: 610mm)

Also available as single.



### Double Wardrobe with 2 Drawers

(H: 1775 W: 800 D: 610mm)

Also available as single.

Shown with optional sloping top box.

## Beds



### Single Bed Base and Headboard

(H: 330 W: 976 D: 2000mm)

To suit mattress 3' wide (ordered separately).

This single bed base has a wipe clean melamine faced panel combined with solid beech hardwood legs and headboard frame. Sturdy mortice and tenoned framing supports 28mm thick pine slats securely fixed with snub-nosed screws. Headboards bolt right through the legs.



### Blocked Base Bed and Headboard

(H: 330 W: 976 D: 2000)

To suit mattress 3' wide (ordered separately).

The Blocked Base bed can easily be fixed to the floor and with a solid base it can withstand severe use while still offering the domestic appeal of our range of colours or wood grains. The Blocked Base can also be made in wider sizes if required.

## Radiata Cutout Range



### Radiata cutout range specifications

- Constructed from solid wood
- Available in a natural or pale cherry finish
- Built to any size or specification
- Filled in plinths and cut out handles to reduce ligature risk
- Other options available in this range include:-  
Anti-tamper screws/Anti-ligature shelf  
Magnetic rail/Sloping wardrobe top



**All Hanging Wardrobe**  
(H: 1900 W: 900 D: 625mm)  
**Sloping Top Box**  
(H: 400 W: 900 D: 625mm)



**3 + 2 Chest of Drawers**  
(H: 916 W: 915 D: 425mm)



**3 Drawer Bedside Cabinet**  
(H: 580 W: 430 D: 425mm)

**For the full range of this furniture please refer to page 17 of this brochure.**



## Lounge/Dining Range



**Round Coffee Table**  
(H: 380 W: 600mm)



**Coffee Table**  
(H: 380 W: 450 D: 750mm)



**Glazed television/Video Cabinet**  
(H: 1020 W: 810 D: 610mm)  
(See price list for additional sizes)



**Rectangular Table**  
(H: 730 W: 915 D: 1500mm)  
(H: 730 W: 915 D: 1800mm)

Also Available:

**Square Table** (H: 730 W: 915 D: 915mm)



**Circular Table**  
(H: 730 W: 1100mm)  
(H: 730 W: 1500mm)



**Sideboard/Dresser**  
(H: 1775 W: 810 D: 545mm)



**Beech Contract Side Chair**  
(H: 890 W: 480 D: 520mm)



**Beech Contract Carver**  
(H: 890 W: 560 D: 520mm)

# Made-to-measure Curtains

Colourways are able to provide a wide range of made to measure curtains, velcro nets, soft furnishings. All fabrics are inherently fire retardant and conform to BS5867 part 2.

Curtains are available with a variety of headings, Velcro tab tops being our speciality. Carers and maintenance alike favour these as they can be easily re-hung without any damage to the plaster or paint work.

We can provide matching bedding, cushions even items such as bumper covers, bolster cushions and valances for high low beds.

To complete the job we have a range of poles and track that can be supplied alongside your curtains, we can even arrange fitting and hanging if you require.

It is often difficult to see exactly what the design or colour will look like, so please call or E-mail for a free fabric sample.



## Accessories

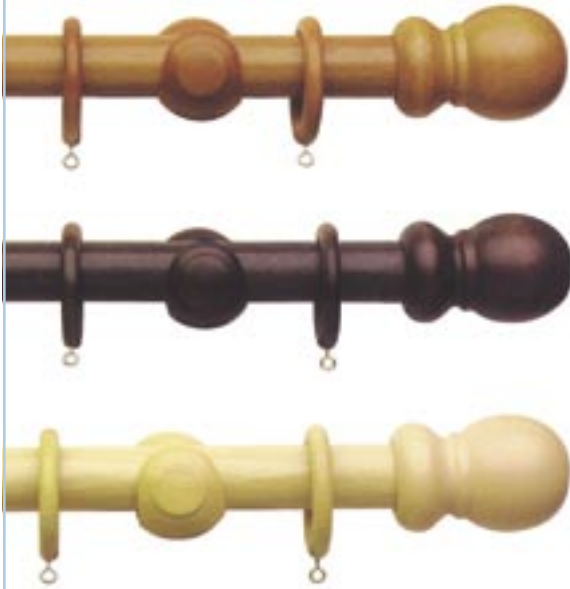

### Classic Wood 35mm Poles

For details and sizes available, please see price list.



### Metal curtain tracks

Suitable for all weights of curtains.  
Easy to bend, to fit bays of all shapes and sizes.

### How to measure

Use a metal tape for accuracy.

All measurements must be given in metric to the nearest whole cm.

We strongly recommend that you install your track or pole before measuring.

#### Curtain width (measurement A):

Measure the track (end to end) or pole (between finials) NOT the window.

#### Curtain drop (measurement B):

Measure from the top of track or from bottom of curtain rings to desired length.

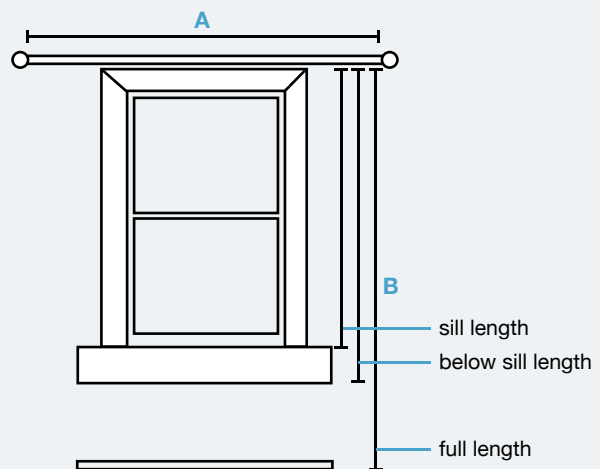



## Fabric Selection & Bedding

Our curtain and bedding patterns are grouped into 6 colour ranges. Once you have chosen your colour we can provide samples and suggestions from our exciting range of patterns, a selection of which can be seen on our website, [www.colourwaysltd.com](http://www.colourwaysltd.com)



Blue



Green



Lilac



Plain



Terracotta



Yellow

For fire retardant bedding and towel colour selection please refer to the price list.



### Plain Bedding

The vibrant range of colours for our inherently flame retardant sheets, valances and pillowcases make the perfect match for our patterns. Choose from the following colours:



Atlantic



Tan



Marine



Claret



Pine

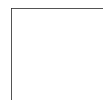

White



Rosebud



Spring Green



Lemon



Ecru

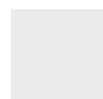

Icicle Grey



Peach



Summer Blue



Jade Green



Cream



Champagne



Sand



Lilac



Powder Pink



Autumn Beige



## Finishing Touches

Choose from our selection of canvas art work. More available at [www.colourwaystld.com](http://www.colourwaystld.com)



**Photographic T**  
50 x 50cm



**Energy**  
50 x 50cm



**Zenith**  
50 x 50cm



**Spring Meadow**  
50 x 50cm

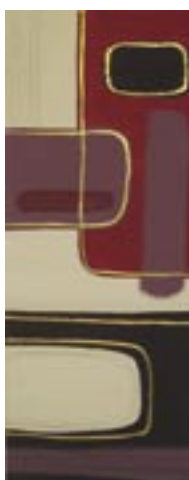

**Vertical B**  
40 x 100cm



**Vertical D**  
40 x 100cm



**Vertical E**  
40 x 100cm



**Vertical A**  
40 x 100cm



**Photographic Lily**  
60 x 70cm



**Holiday**  
60 x 70cm



**Mural**

## Plants

All artificial plants are flame retardant. Decorative planters sold separately (see price list).  
Plants can be potted and sealed at a small extra cost.



**5.5' Ficus Benjamina**



**6' Japanese Red Maple**



**7' Kentia Palm**



**Black Polished Fibreglass Planters**  
See price list for details.

## Office Furniture



### Office furniture available

- Built to your specification or supplied 'off the shelf'
- Filing cabinets/Chairs/Lockers/Key and Drug cabinets



#### Lockers

- 1800 x 300mm
- Variety of colours
- Up to 6 compartments
- Epoxy coated steel

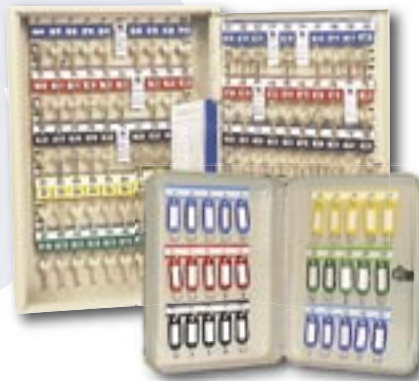

#### Key Cabinet

- Variety of sizes available
- Colour coded tags
- Metal construction
- Sturdy lock



#### Drugs Cabinet

- Steel wall cabinet
- Comply with BS2881/1989
- Range of sizes
- With or without blister frames



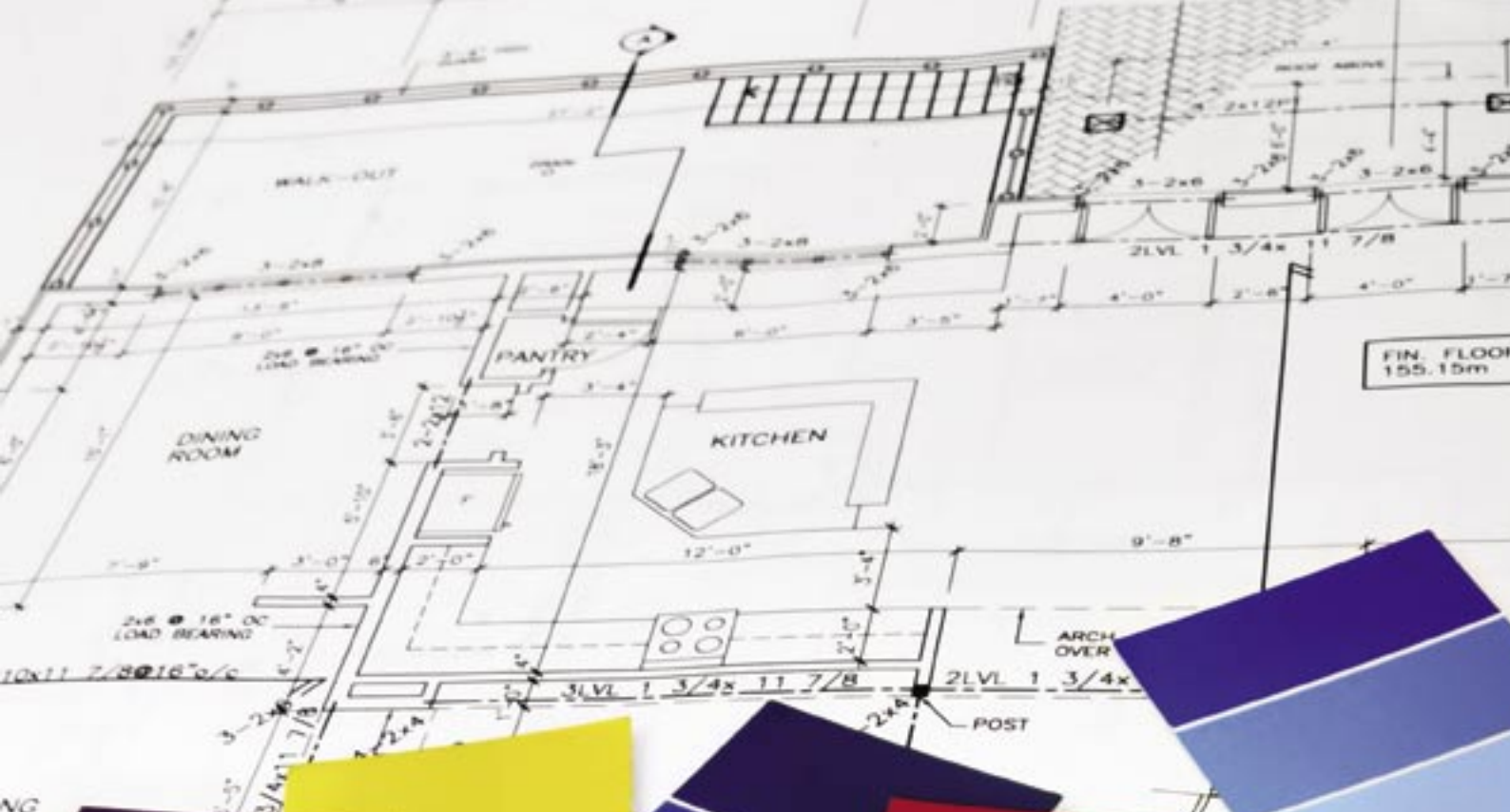

## Room Colors

Kitchen :  
Livingroom :  
Bedroom 1 :  
Bedroom 2 :  
Bathroom :





*A new concept in contract design*

# Colourways

**Tel:** 01489 580978 **Fax:** 01489 579722

**Email:** [sales@colourwaysltd.com](mailto:sales@colourwaysltd.com) [www.colourwaysltd.com](http://www.colourwaysltd.com)